



**Continental Disc<sup>®</sup>  
Corporation**

GEP-6811  
Rev. C 22991  
Ref. ID: 15984

## Installation and Operation of the Fluid-Trol III Hose Valve w/Swivel and Adapter

### WARNING

USER SHOULD READ AND THOROUGHLY UNDERSTAND THESE INSTRUCTIONS BEFORE INSTALLING HOSE VALVE. THESE INSTRUCTIONS DO NOT PURPORT TO ADDRESS ALL OF THE SAFETY FACTORS ASSOCIATED WITH THE HOSE VALVE'S USE IN SERVICE. IT IS THE RESPONSIBILITY OF THE USER TO ESTABLISH APPROPRIATE SAFETY, HEALTH, AND TRAINING MEASURES FOR THEIR PERSONNEL INSTALLING, SERVICING, OR WORKING IN AN AREA WHERE HOSE VALVES ARE IN USE.

THE FLOW OF MEDIA THROUGH A VALVE CAN CREATE LOUD NOISES. THE CUSTOMER AND/OR USER SHALL BE RESPONSIBLE FOR PROTECTING AGAINST HEARING DAMAGE OR ANY OTHER DAMAGE TO BYSTANDERS FROM THIS LOUD NOISE.

THE CUSTOMER AND/OR USER SHALL BE RESPONSIBLE FOR ASSURING THAT THE FLOWING MEDIA IS DIRECTED INTO A SAFE AREA TO PREVENT PERSONAL INJURY OR DAMAGE TO EQUIPMENT OR ANY OTHER PROPERTY DAMAGE. DO NOT POINT THE VALVE TOWARD YOURSELF OR ANY OTHER PERSONNEL.

THERE IS NO GUARANTEE OF VALVE LIFE. SUCH LIFE SPAN IS AFFECTED BY CORROSION, EROSION, AND PHYSICAL DAMAGE. THESE CONDITIONS WILL AFFECT THE SEAT TIGHTNESS AND PRESSURE RETAINING CAPABILITY OF THE VALVE. NOT RECOMMENDED FOR USE IN AREAS OF HIGH MECHANICAL ABUSE, WHERE IT MAY BE REPEATEDLY HIT OR DROPPED. DAMAGE TO THE VALVE MAY OCCUR AS THE RESULT OF BEING DROPPED. DAMAGE TO THE VALVE MAY RESULT IN INJURY TO PERSONNEL OR DAMAGE TO OTHER EQUIPMENT. CUSTOMER AND/OR USER SHOULD PERIODICALLY CHECK FOR TIGHTNESS OF ALL CONNECTIONS AND TIGHTNESS OF THE SWIVEL CONNECTOR IF SO EQUIPPED.

CUSTOMER AND/OR ITS INSTALLER SHALL BE RESPONSIBLE FOR THE PROPER INSTALLATION OF SELLER'S VALVES INTO A SYSTEM. CUSTOMER AND/OR ITS INSTALLER SHALL BE RESPONSIBLE FOR IMPROPER INSTALLATION AND PHYSICAL DAMAGE RESULTING THEREFROM, INCLUDING, BUT NOT LIMITED TO, DAMAGE RESULTING FROM LEAKAGE, IMPROPER TORQUING AND FAILURE TO FOLLOW INSTALLATION INSTRUCTIONS. THE LIMITED WARRANTY HEREINABOVE SET FORTH SHALL NOT APPLY TO ANY OF SELLER'S PRODUCTS WHICH ARE IMPROPERLY INSTALLED.

CONTINENTAL DISC CORPORATION ASSUMES NO LIABILITY FOR THE INSTALLATION. ALL CONSIDERATION MUST BE GIVEN TO PREVENT PERSONAL INJURY OR PROPERTY DAMAGE.

### I. INSTALLATION

1. Push the air hose fully onto the barbed end of the hose adapter. Secure the hose to the hose adapter with an appropriate size worm drive hose clamp.
2. If the Fluid-Trol III hose valve unit **contains a swivel**, thread the female end of the swivel onto the hose adapter. Ensure that the adapter O-ring is in place. Using a wrench, tighten the swivel unit against the hose adapter. Thread the hose valve onto the swivel. Ensure that the swivel O-ring is in place. Using a wrench, tighten the swivel against the hose valve.
3. If the Fluid-Trol III hose valve unit **does not contain a swivel**, thread the hose valve itself onto the hose adapter. Ensure that the adapter O-ring is in place. Using a wrench, tighten the hose adapter against the hose valve.
4. Make sure that the nozzle or wand extension is securely threaded into the hose valve. For air service valves, ensure that the side ports on the nozzle are clear from obstructions. This is necessary for OSHA compliance.

**CAUTION: FOR WAND EXTENSIONS WE RECOMMEND APPLYING A LIQUID THREAD LOCKER FOR A PERMANENT ASSEMBLY.**

## II. OPERATION

**CAUTION: DO NOT EXCEED 150 PSIG INLET PRESSURE TO THE VALVE.**

**THE AIR SERVICE NOZZLE IS DESIGNED TO MEET THE REQUIREMENTS OF OSHA STANDARDS, PARAGRAPH 1910.242(B), UP TO A MAXIMUM HOSE VALVE INLET PRESSURE OF 150 PSIG OF AIR.**

1. Grasping the Fluid-Trol III hose valve unit in your hand, depress the lever to allow flow through the hose valve.
2. To stop the flow, release the lever.

## III. MAINTENANCE

It is recommended that the Buna-N o-ring and the tip of the hose valve stem be lubricated on a regular basis to minimize wear and enhance the o-ring sealing capabilities. The frequency of this maintenance is dependent on the operating conditions encountered and shall be established by the user. See Figure A.

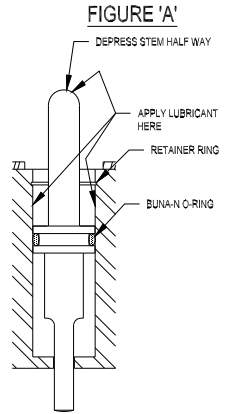

## IV. CUSTOMER SERVICE

If you wish to discuss a particular application, installation, or maintenance concern, please contact the Customer Service Department at Corporate Headquarters at the address shown below. Additional valves or accessories may be ordered by contacting your local CDC representative or by contacting Continental Disc Corporation directly.

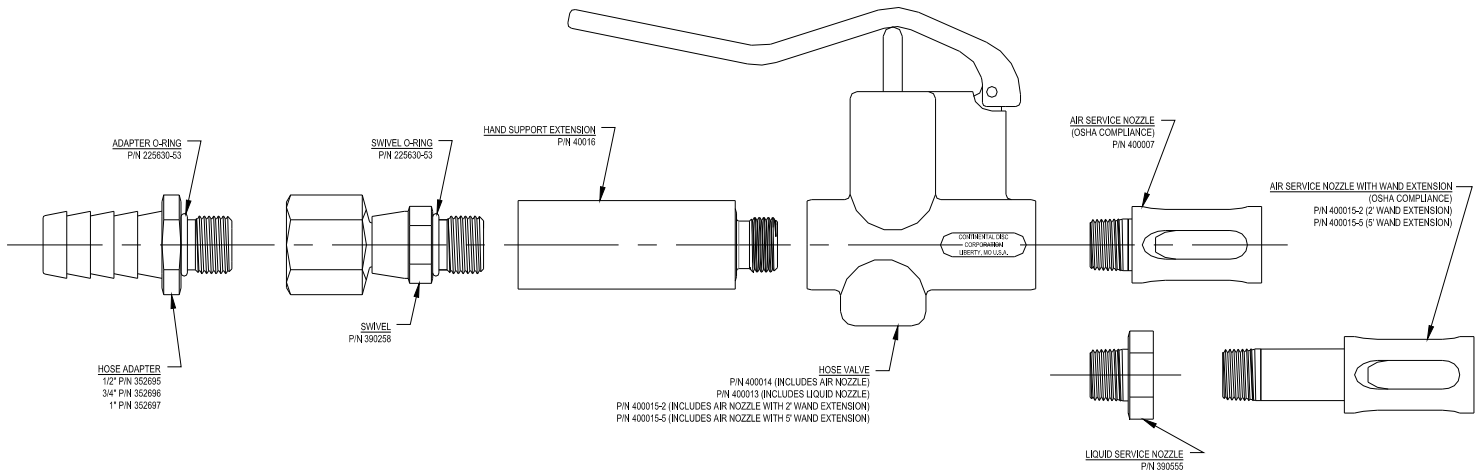

Continental Disc Corporation has representatives located throughout the world. Contact the office nearest you for the authorized representative in your area.



HEADQUARTERS //  
3160 W. Heartland Drive  
Liberty, MO 64068 USA  
Ph (816) 792 1500 | Fax (816) 792 2277  
sales@contdisc.com

contdisc.com

**THE NETHERLANDS**  
Energieleweg 20, 2382 NJ Zouterwoude-Rijndijk  
The Netherlands  
Ph +[31] 71 5412221 | Fax +[31] 71 5414361  
cdcnl@contdisc.com

**CHINA**  
Room 910, Tower B, COFCO Plaza  
No. 8 JianGuoMenNei Avenue  
Beijing (100005), P.R. China  
Ph +[86] 10 522 4885 | Fax +[86] 10 6522 2885  
cdcchina@contdisc.com

**INDIA**  
423/P/11, Mahagujarat Industrial Estate, Moraiya,  
Sarkhej-Bavla Road, Ahmedabad (GJ)  
382213 INDIA  
Ph +[91] 2717 619 333 | Fax +[86] 10 6522 2885  
gcempl@contdisc.com